

UPS

SPECIFICATIONS

Capacity	800VA	1200VA
Input voltage	145-290VAC	
Output voltage	200-255VAC	
Output wave form	PWM/DC	
Output frequency	50Hz or 60Hz	
Battery rating	12.8V/76.8WH LiFePO4	25.6V/153.6WH LiFePO4
Backup time	100W Load≈33min	200W Load≈33min
Noise level	Less than 45 dB	
Operating temperature	0~45 deg C	
Humidity	10 to 90% non condensing	
Dimensions	225*85*141(mm)	305*85*141(mm)

TEST THE UPS

To test UPS on battery back-up, switch off utility supply and observe 'backup Indicator' lights. Also your PC should continue to function normally.

1. Switching on

Press the switch for 3 seconds, the LED display output voltage. then the UPS will be ready for operation.

2. Autorun

In DC mode,UPS discharges till battery run out and cut off,UPS autorun when AC recover.

3. Overload protection

When UPS is overloaded while operating, which is not solved by the user in time, it will cut off the output automatically after some time, then turn back to operation mode.

4. Low battery shut off

When the battery is about to be exhausted, UPS will shut down automatically to protect battery's life.

5. Switching off

1) AC Normal

UPS will cut off the output and goes to AC standby mode by pressing the switch for 3 seconds.

2) Backup

Press the switch for 3 seconds , the UPS will be turned off after a long beep.

TROUBLE SHOOTING

The trouble shooting chart covers most of the difficulties that you may encounter under normal working conditions. If the UPS fails to operate properly, please review the following steps before calling the service center.

1. Is the UPS plugged into a correct working outlet?
2. Is the line voltage within the rating specified?
3. Is the fuse / circuit protector on back panel open?

Please submit the following information when you call for service.

1. Model No. & Serial No.
2. Date of problem.
3. Full description of problem.

TROUBLE SHOOTING CHART

SYMPTOMS	POSSIBLE CAUSES	ACTIONS TO TAKE
UPS can not be turned ON	UPS is not connecting to AC and overloaded	Please connect to AC and reduce the load
	The input fuse is burnt or breaker is off	Replace the fuse or reset the breaker, remove some load and check if the load is short-circuit or faulty
	AC Input voltage is too low	Please check the AC Input voltage
	The UPS is failure	Please send to the agency to repair
The buzzer beep every 8 seconds	UPS suddenly turns to battery mode in spite of utility line present	Save the data promptly and shut down the operating system
The buzzer beep every second	Back-up time less than 1 minute	Close the system and recharge again
Back-up time less than specified	Overloaded	Please reduce the load
	Battery is not fully charged	Recharge the battery for at-least 12 hours and retest the backup time
	Charging unit fault	Please send to the agency to repair

GUARANTEE CERTIFICATE

Serial No.: _____

Customer's Name: _____

Contact Person: _____

Address: _____

Telephone No.: _____

Product/Model: _____

Post Code: _____

Fax No.: _____

Date of purchase: _____

Expire Date: _____

Dealer Signature: _____

Customer Signature: _____

UPS

THIS MANUAL CONTAINS IMPORTANT SAFETY INSTRUCTIONS. KEEP THIS MANUAL HANDY FOR FUTURE REFERENCE.

INSTALLATION AND OPERATION

Before installation, please read and understand the following instructions:
Inspect the following items inside box

- ※User's Manual
- ※UPS
- ※Mains Cord

UNPACKING AND INSPECTION

Examine the packing carton for damage. Notify your dealer immediately if damage is observed. Store the packing in a safe place for possible future trans-shipment of the UPS.

PLACE THE UPS

Position the UPS on a sturdy, dry surface in a well-ventilated area away from direct sources of heat. Leave at least 100 mm clearance all around the UPS to provide adequate ventilation.

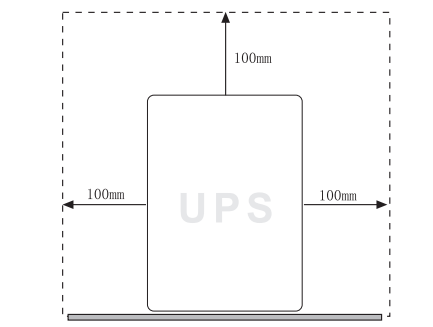

The UPS is intended for indoor use only. Although your UPS is very rugged, its internal components are not sealed from the environment. Kindly note the following.

- ※Avoid direct sunlight.
- ※Avoid excessive heat.
- ※Avoid excessive humidity or liquids.
- ※Avoid excessive dust.



CONNECT UPS TO POWER

Connect the Power Cord, to a verified grounded 3-wire receptacle. Do not power the UPS using a surge suppressor or power strip. Switch the utility power ON.

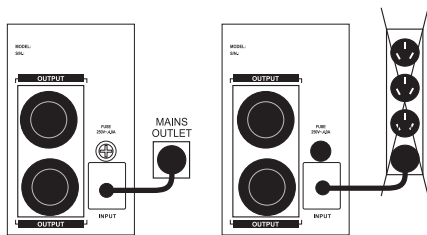

CONNECT EQUIPMENT TO UPS

Now connect your load to be protected (computer, monitor etc.) to the AC Output receptacles at the rear of the UPS.

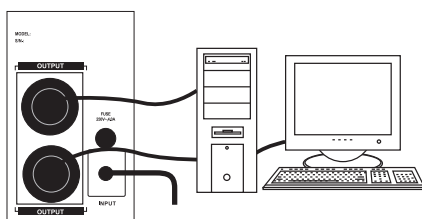

- ※Do not connect a Laser Printer or any non-computer peripherals to UPS outlets.
- ※Do not connect a surge suppressor, power strip, or extension cord to the UPS outlet.

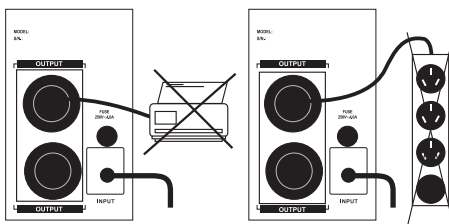

Enable the UPS by turning on the Power ON/OFF switch, which is situated on the front panel.

The UPS is now ready to use. Switch on your equipment and you are ready to function.

Safety Notice

The product contains voltages, which are potentially hazardous. Qualified service personnel should perform all repairs.

Do not try to open the cover and to service the system yourself, no user serviceable parts inside. Refer servicing to qualified service personnel only. The product has its own internal energy source (battery). The output receptacles may be live even when the product is not connected to an AC supply.

Warning

In case of fire risky, please change the fuse with the same kind and same rate.

The product is intended for indoor use only. Kindly note to avoid excessive heat, dust, humidity or liquids.

BATTERY MAINTENANCE / BATTERY CHARGING

AFTER SHIPMENT FROM THE FACTORY THE BATTERY NEEDS RECHARGING. IF NOT USED FOR A LONG PERIOD OF TIME, THE BATTERY WILL START SELF-DISCHARGING, WHICH MAY RESULT IN A SHORT SERVICE LIFE OF THE BATTERY OR MAY EVEN CAUSE DAMAGE TO IT DURING WARRANTY PERIOD. CARE SHOULD ALSO BE TAKEN TO AVOID EXCESSIVE TEMPERATURE AROUND THE UPS, WHICH COULD ALSO RESULT IN REDUCING SERVICE LIFE OF THE BATTERY. TO ACHIEVE MAXIMUM SERVICE LIFE FROM THE BATTERY THE ABOVE INSTRUCTIONS SHOULD BE FOLLOWED.

The UPS battery charges whenever the UPS is connected to utility power & is switched ON. It typically requires more than 12 hours to charge fully. Operating runtime is reduced until the battery is fully charged.

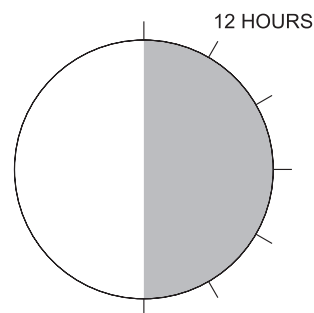

UPS Indicators and controls

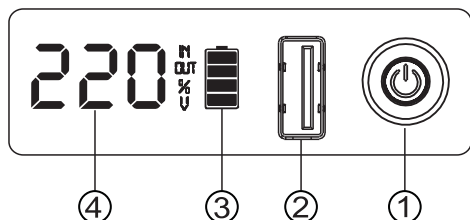

- ① ON/OFF Switch
- ② USB Output(5V/2A)
- ③ Battery Capacity
- ④ The output voltage is displayed by default

Press the ON/OFF button to switch the display for the following parameters in turn:

Load percentage

Load level (included "1.2.3" three levels, the higher the level, the greater the load)

Mains input voltage